

test.zmdx.at

SARS-CoV-2 PCR TEST

WITH MOUTH/THROAT RINSE
FOR SELF-TESTING

INSTRUCTIONS

 ZENTRUM FÜR
MOLEKULARE
DIAGNOSTIK



TESTING PROCESS



test.zmdx.at



1



REGISTER ONLINE

Register at test.zmdx.at.
Enter your personal details.



2



COLLECT A FREE PCR TEST

Select collect a PCR gargle test
in the online app and confirm.
Show your collection confirmation at
the checkout of a participating
branch/pharmacy.



Take the PCR
test back home.

3



GARGLE AS PER THE INSTRUCTIONS

Record yourself carrying
out the test.

4

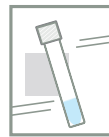

PACKAGE SAMPLE

Once the test is completed, place the
sample, including the cellulose
wadding, into the protective bag.

Keep the instructions for use.



5



RETURN SAMPLE

Deposit the protective bag containing
the sample in the drop box at a
participating branch/pharmacy.
A laboratory analysis will be carried out
within 24 hours from collection of the
sample (see drop box).



6



RECEIVE RESULT

Receive result by text message.
The official COVID-19 certificate*
can be retrieved via the link
in the text message.

*Only with valid identification



SARS-CoV-2 PCR TEST

WITH MOUTH/THROAT RINSE
FOR SELF-TESTING

PCR Test Kit

- 1 Saline solution
- 2 Transfer tube
- 3 Sample tube
- 4 Protective bag
- 5 Cellulose wadding
- 6 PCR test package
- 7 Instructions for use



ONLINE APP PORTAL



Registration portal:
Scan the QR code or follow
the link: test.zmdx.at

test.zmdx.at

English ▾

ZENTRUM FÜR
MOLEKULARE
DIAGNOSTIK

COVID-PORTAL

Email address:

Password:

[Forgot password?](#)

Login

PCR gargling test
[Instructions \(PDF\)](#) [Video instruction](#)

PCR lollipop test (Kindergarten testing)
[Instructions \(PDF\)](#) [Video instruction](#)

Not yet registered?
Register now

In case of questions please contact:
portal@zmdx.at

REGISTER using your
e-mail address and
choose a password.

Take care to ensure that your inbox
has space and that you have entered
your e-mail address correctly.

test.zmdx.at

ZENTRUM FÜR
MOLEKULARE
DIAGNOSTIK

COVID-PORTAL
Registration

Please choose what you would like to register for:

| | |
|--------------------------|--------------------------|
| Tourismus Choose | Kärnten Choose |
| Steiermark Choose | Vorarlberg Choose |

**Choose what you would
like to register for.**

test.zmdx.at

ZENTRUM FÜR
MOLEKULARE
DIAGNOSTIK

COVID-PORTAL
Registration
for Burgenland

First name:

Last name:

Email:

Password:

Confirm password:

The password must contain at least:

- 10 characters
- one uppercase letter
- one lowercase letter
- one digit

I have read and understood the [Privacy policy](#)
and consent to the processing of my personal data

Enter your details here.

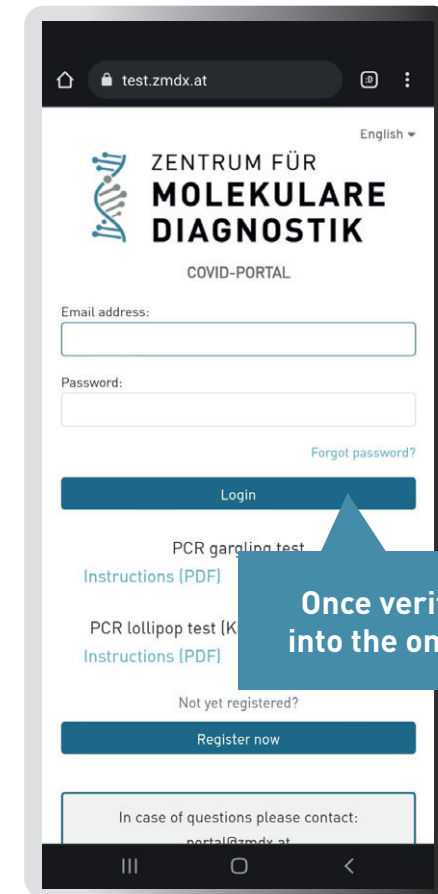
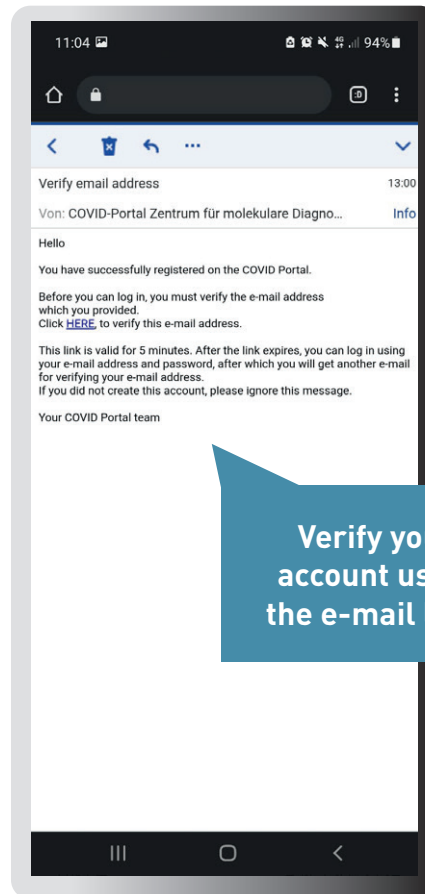
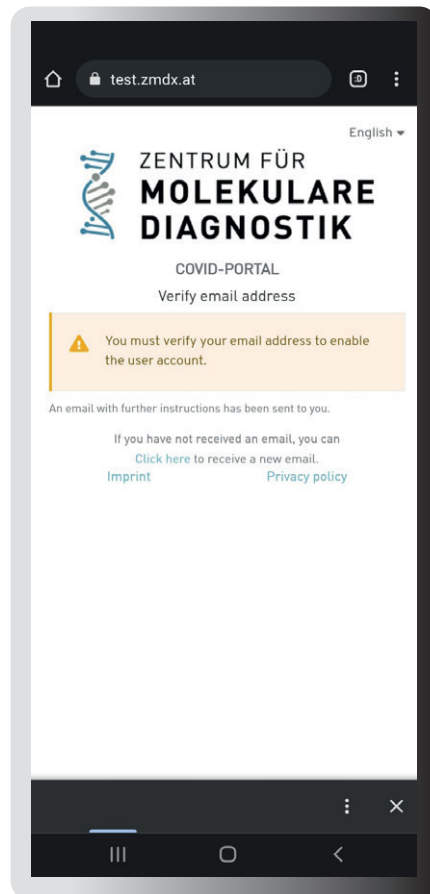

test.zmdx.at

Personal details English

Save

If you do not provide any ID information, you will only receive a test result.

If you provide your ID certificate (Green Pass) Click on Scan ID to automatically enter your details. Or click on Enter manually to enter your details manually.

Scan ID

ID type:

ID number:

Expiry date:

ID photo:

Upload ID photo

Save

Provide your ID information
(for Green Pass).

test.zmdx.at

Personal details English

Save

Select person for testing

Please select the persons whose details you want to modify:

+ New person added successfully

Personal information

Gender: *

Title:

First name: *

Last name:

Insurance number:

If you want to add more people,
select "New person".

Fill in your details.

test.zmdx.at

Collect gargle PCR test ... English

Collect gargle PCR test kit

You have 3 more gargle PCR tests available.

How many PCR gargling tests do you want to collect?

- 3 +

Warning: Please perform this action immediately before the collection of the test kit at the collection station as the following confirmation is valid for 20 minutes and must be confirmed.

? How many tests do you want to collect for?

? Where can I collect my PCR gargling tests?

? What do I need to bring with me when picking up my tests?

ZENTRUM FÜR MOLEKULARE DIAGNOSTIK

Now select how many
PCR gargle tests you
would like to collect.

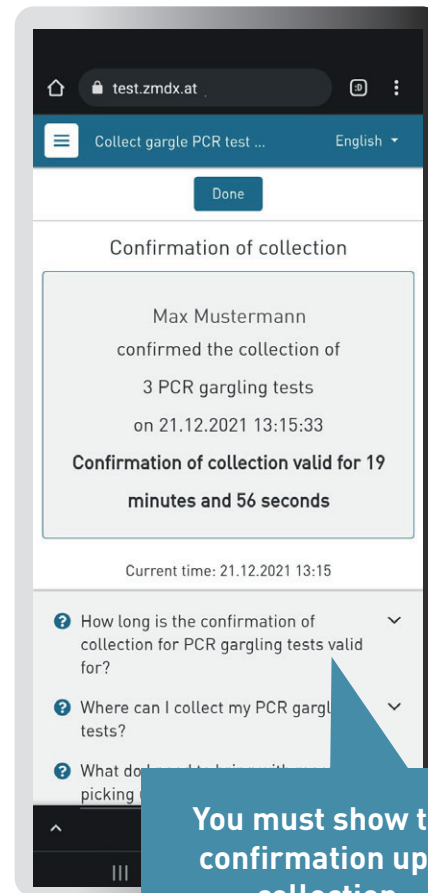
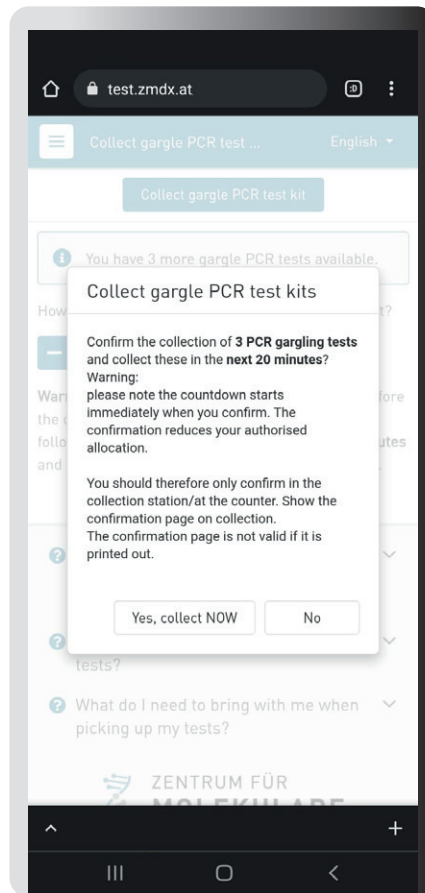

You must show this confirmation upon collection.

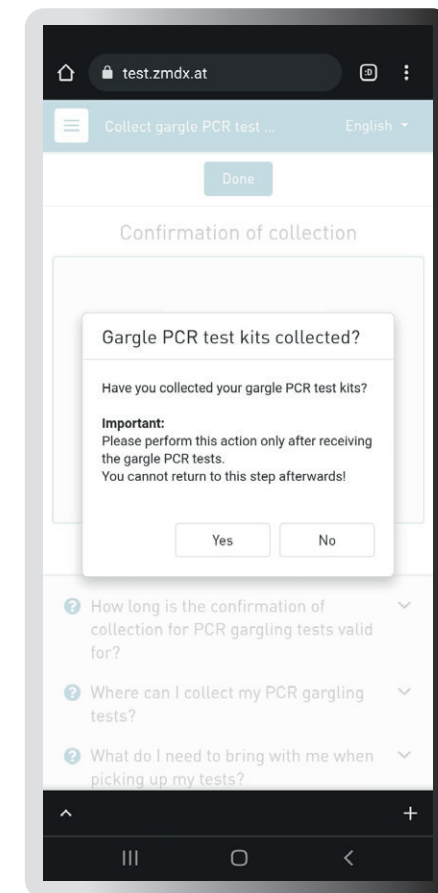

Now go to
Start the PCR test.

Start PCR test English

Continue

Start

1 2 3 4

Activate sample

Enter your full sample number. If you are using a mobile phone or a device with a camera, you can also scan your sample number. Please click on the blue Scan button. You will find your sample number on the sample tube that came with your testing kit.

After entering your sample number, you can enter the details of the person taking the test. Then perform the test. If you are testing several people, please repeat this step and register each person in turn.

Sample number: *

Scan

Where can I find the sample number?

To scan your sample number, please click on the blue "Scan" button and hold the sample number in front of the camera (mobile phone/webcam). Alternatively, you can enter your sample number manually. Please make sure you enter the sample number correctly.

Activate the sample number
of the gargle test you are
using here.

Now go to start the
PCR gargle test.

Start PCR test English

Continue

After entering your sample number, you can enter the details of the person taking the test. Then perform the test. If you are testing several people, please repeat this step and register each person in turn.

Sample number: *

Scan

Where can I find the sample number?

How can I scan the sample number?

To scan your sample number, please click on the blue "Scan" button and hold the sample number in front of the camera (mobile phone/webcam). Alternatively, you can enter your sample number manually. Please make sure you enter the sample number correctly.

Where can I collect the gargle PCR test kits?

Where can I hand in completed gargle PCR tests?

What materials does a gargle PCR test kit contain?

To finish the test, make
sure to select "Done".

Start PCR test English

Done

Pack

1 2 3 4

Pack sample

Almost there!

- Place the sealed sample tube in the protective bag.
- Make sure that the genetic material is inside the protective bag.
- If you deposit your sample by 10:00 am, you will receive your test result the same day. If you deposit your sample after 10:00 am, you will receive your test result within 24 hours.

Where can I deposit completed PCR gargling tests?

Why do I need to keep the instructions for use?

DIRECTIONS FOR TAKING THE TEST

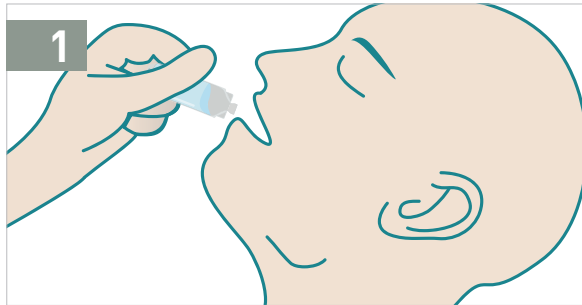

1. Open the saline solution, pour it into your mouth and swirl/gargle it thoroughly for at least 1 minute.

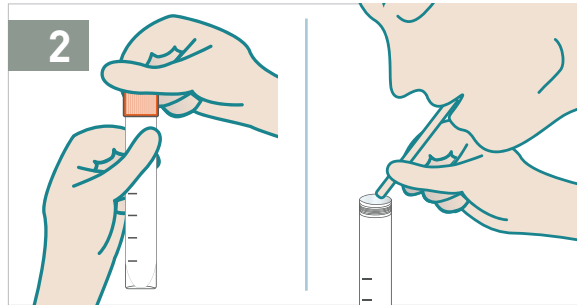

2. Open the sample tube. Take the transfer tube and use it to spit the swirled saline solution into the sample tube.

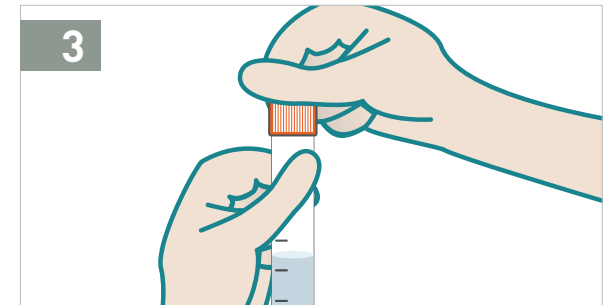

3. Replace the cap on the sample tube containing the sample.

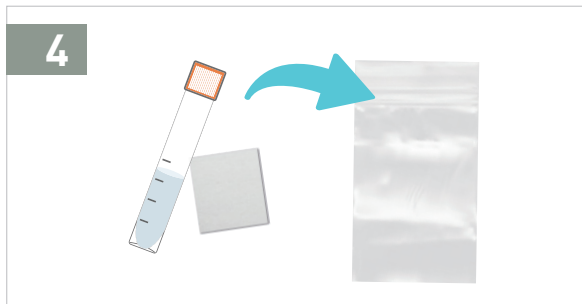

4. Put the sample tube in the protective bag with the cellulose wadding. Then close the protective bag carefully.

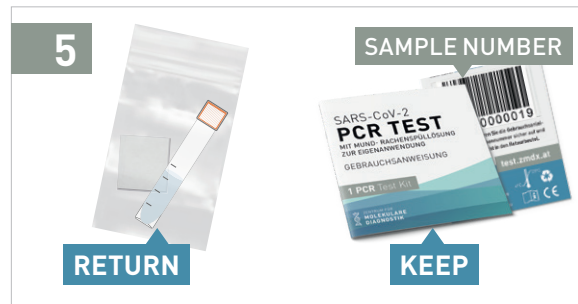

5. Keep the instructions for use with your sample number in a safe place and never put it in the protective bag.



6. Take the protective bag containing the sample to a drop-off point immediately after taking the test. See online app.